



- ❑ **630 to 32000 lt capacity**

- ❑ **Heating with jacket or half coil**

- ❑ **Agitator**

presslock detachable blades agitator

- ❑ **1 piece execution**

top cover welded to lower shell

- ❑ **Design conditions**

Pressure: -1 / 6 bar for vessel and jacket

Temperature: -25 / +200°C

- ❑ **Features**

Available for insulation and stainless steel cladding on lower and bottom head

Available for insulation and stainless steel cladding on top head

Available with top head in carbon steel nickel plating

Supportation: ring, brackets, legs according customer need

DIN 28136 type BE Reactors 1000 It to 6300 It

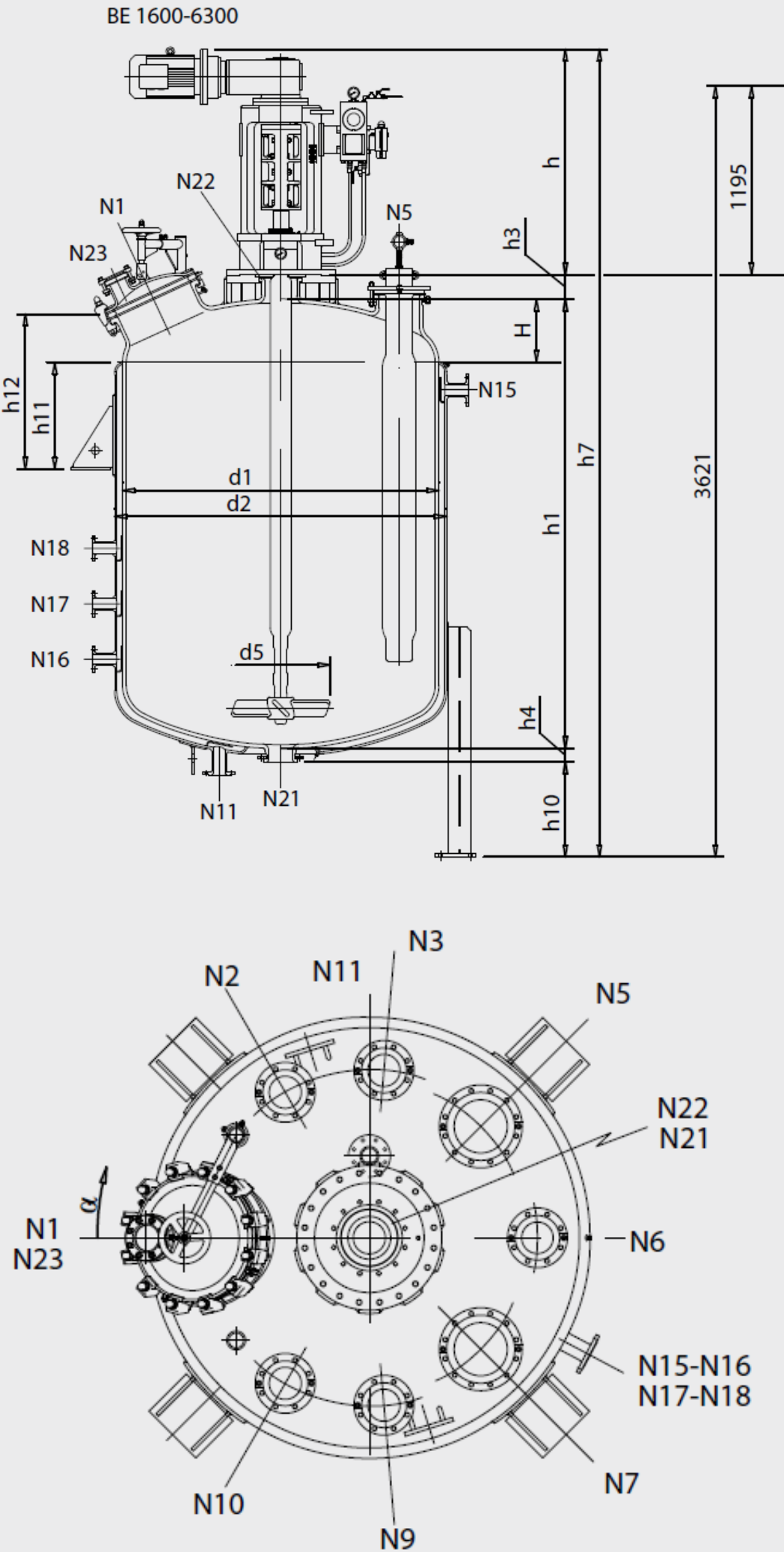

Type	Tipo	BE	1000	1600	2500	4000	6300
Vessel capacity	Volume interno	l	1485	2340	3500	5425	8820
Jacket capacity	Volume camicia	l	220	350	430	550	760
Jacketed area	Superficie incamiciata	m²	4.6	7.3	9.6	13.2	18
Weight	Peso	kg	2200	3100	5100	6100	7500
Dimensioni Dimensions	d1	mm	1200	1400	1600	1800	2000
	d2	mm	1300	1500	1700	1900	2100
	H	mm	240	280	320	360	400
	h1	mm	1560	1800	2060	2500	3050
	h3	mm	90	100	100	130	130
	h4	mm	76	74	72	70	86
	h7	mm	3621	3926	4209	4811	5602
	h10 min.	mm	700	700	700	700	900
	h11 min.	mm	320	380	380	545	535
	h12 min.	mm	530	600	620	810	820
	h13 min.	mm	310	240	240	250	270
	h14 min.	mm	520	460	480	515	555
Boochelli Nozzles	N1	DN	350/450	350/450	500	500	500
	N2	DN - h5	100 - 30	100 - 25	100 - 10	150 - 0	150 - 0
		R - α	500 - 67.5°	575 - 60°	675 - 65°	725 - 65°	800 - 60°
	N3	DN - h5	100 - 30	100 - 25	100 - 10	150 - 0	150 - 0
		R - α	500 - 95°	575 - 95°	675 - 95°	725 - 95°	800 - 95°
	N5	DN - h5	200 - 60	200 - 50	200 - 50	250 - 25	250 - 25
		R - α	450 - 137.5°	550 - 135°	625 - 135°	675 - 135°	750 - 135°
	N6	DN - h5	100 - 30	100 - 25	100 - 10	150 - 0	150 - 0
		R - α	500 - 180°	575 - 180°	675 - 180°	725 - 180°	800 - 180°
	N7	DN - h5	200 - 60	200 - 50	200 - 50	250 - 25	250 - 25
		R - α	450 - 222.5°	550 - 225°	625 - 225°	675 - 225°	750 - 225°
	N9	DN - h5	100 - 30	100 - 25	100 - 10	150 - 0	150 - 0
		R - α	500 - 265°	575 - 265°	675 - 265°	725 - 265°	800 - 265°
	N10	DN - h5	100 - 30	100 - 25	100 - 10	150 - 0	150 - 0
		R - α	500 - 292.5°	575 - 300°	675 - 295°	725 - 295°	800 - 300°
Boochelli Camicia Jacket Nozzles	N21	DN	100	100	100	100	150
	N22	DN	125	150	150	200	200
	N23	DN	100	100	100	100	100
	N11	DN - α	50 - 90°	50 - 90°	50 - 90°	50 - 90°	80 - 90°
	N15	DN - α	50 - 208°	50 - 208°	50 - 208°	50 - 208°	80 - 208°
Gruppo Drive	N16	DN - α	50 - 208°	50 - 208°	50 - 208°	50 - 208°	50 - 208°
	N17	DN - α	-	-	-	50 - 208°	50 - 208°
	N18	DN - α	-	-	-	-	50 - 208°
Turbina Turbine	Drive type	-	GNA-60	GRO-80	GRO-80	GRO-100	GRO-100
	Max torque	Nm	500	1400	1400	2800	2800
	h	mm	1195	1247	1272	1406	1431
	d5	mm	625	625	740	740	740
	na	Rpm	120	103	104	105	107
	Pa	kw	3	4	5.5	7.5	11

DIN 28136 type BE Reactors 8000 It to 32000 It

Reattori BE
Capacità da 8000 a 40000 l
BE type Reactors
Capacity from 8000 to 40000 l

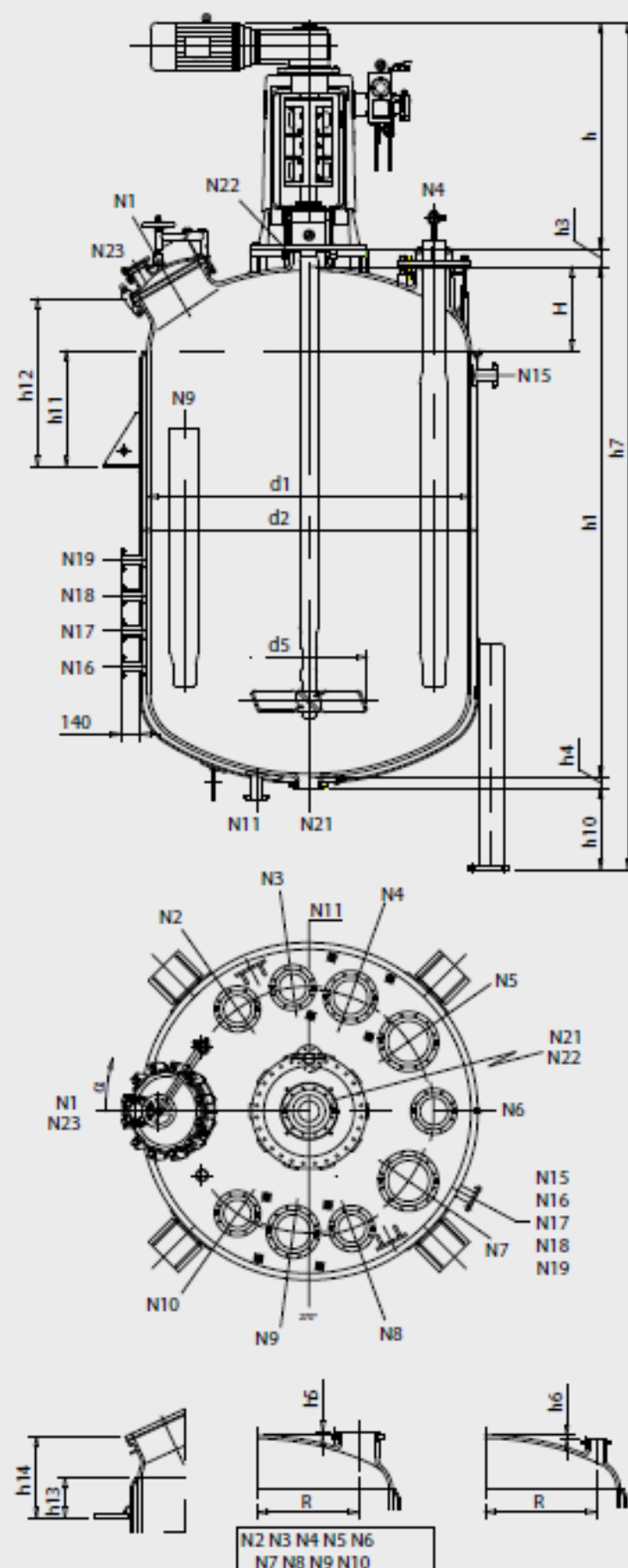

Type	Tipo	BE	8000	10000	12500	16000	16000	20000	25000	25000	32000	32000	40000
Vessel capacity	Volume interno	l	9335	11710	14305	18190	18720	22730	27750	28315	35940	36700	44700
Jacket capacity	Volume camicia	l	750	885	1060	1165	1125	1345	1615	1495	2770	2645	3215
Jacketed area	Superficie incamiciata	m²	17.9	20.6	25.2	29.5	28.2	34.2	41.7	39.8	47.4	45.6	55.4
Weight	Peso	kg	8700	11700	12700	15500	16200	19000	21300	22600	27700	29700	34000
Dimensioni Dimensions	d1	mm	2200	2400	2400	2600	2800	2800	2800	3000	3200	3400	3400
	d2	mm	2300	2500	2500	2700	2900	2900	2900	3100	3300	3500	3500
	H	mm	570	621	621	673	724	724	724	776	825	879	879
	h1	mm	3000	3180	3780	4080	3705	4385	5235	4755	5280	4875	5795
	h3	mm	130	135	135	135	135	135	135	135	135	135	135
	h4	mm	86	84	84	82	82	80	80	80	78	76	76
	h7	mm	5547	5976	6576	6899	6524	7251	8101	7621	8409	8002	8922
	h10 min.	mm	900	900	900	900	900	900	900	900	900	900	900
	h11 min.	mm	500	550	550	600	600	600	600	650	675	725	725
	h12 min.	mm	885	955	955	1050	1070	1070	1070	1145	1190	1280	1280
	h13 min.	mm	240	245	245	245	245	245	245	255	270	275	275
	h14 min.	mm	625	650	650	696	715	715	715	750	785	830	830
Bocchelli Nozzles	N1	DN	600	600	600	600	600	600	600	600	600	600	600
	N2	DN-h5-h6	150-/-40	200-/-40	200-/-40	200-/-65	200-/-75	200-/-75	200-/-75	200-/-90	200-/-100	200-/-90	200-/-90
		R-α	840-50°	925-55°	925-55°	1025-55°	1100-50°	1100-50°	1100-50°	1175-50°	1250-50°	1300-50°	1300-50°
	N3	DN-h5-h6	150-/-40	200-/-40	200-/-40	200-/-65	200-/-75	200-/-75	200-/-75	200-/-90	200-/-100	200-/-90	200-/-90
		R-α	840-77.5°	925-82.5°	925-82.5°	1025-82.5°	1100-77.5°	1100-77.5°	1100-77.5°	1175-77.5°	1250-77.5°	1300-77.5°	1300-77.5°
	N4	DN-h5-h6	150-/-40	250-/-15	250-/-15	250-/-20	300-/-5	300-/-5	300-/-5	300-/-30	400-/-40	400-/-30	400-/-30
		R-α	840-110°	900-110°	900-110°	950-110°	1000-110°	1000-110°	1000-110°	1075-110°	1150-110°	1200-110°	1200-110°
	N5	DN-h5-h6	300-10-/-	300-/-15	300-/-15	300-/-20	400-/-5	400-/-5	400-/-5	400-/-30	400-/-40	400-/-30	400-/-30
		R-α	800-145°	900-145°	900-145°	950-145°	1000-145°	1000-145°	1000-145°	1075-145°	1150-145°	1200-145°	1200-145°
	N6	DN-h5-h6	150-/-40	200-/-40	200-/-40	200-/-65	200-/-75	200-/-75	200-/-75	200-/-90	200-/-100	200-/-90	200-/-90
		R-α	840-180°	925-180°	925-180°	1025-180°	1100-180°	1100-180°	1100-180°	1175-180°	1250-180°	1300-180°	1300-180°
	N7	DN-h5-h6	300-10-/-	300-/-15	300-/-15	300-/-20	400-/-5	400-/-5	400-/-5	400-/-30	400-/-40	400-/-30	400-/-30
		R-α	800-215°	900-215°	900-215°	950-215°	1000-215°	1000-215°	1000-215°	1075-215°	1150-215°	1200-215°	1200-215°
	N8	DN-h5-h6	150-/-40	200-/-40	200-/-40	200-/-65	200-/-75	200-/-75	200-/-75	200-/-90	200-/-100	200-/-90	200-/-90
		R-α	840-250°	925-250°	925-250°	1025-250°	1100-250°	1100-250°	1100-250°	1175-250°	1250-250°	1300-250°	1300-250°
	N9	DN-h5-h6	150-/-40	250-/-15	250-/-15	250-/-20	300-/-5	300-/-5	300-/-5	300-/-30	400-/-40	400-/-30	400-/-30
		R-α	840-282.5°	900-277.5°	900-277.5°	950-277.5°	1000-282.5°	1000-282.5°	1000-282.5°	1075-282.5°	1150-282.5°	1200-282.5°	1200-282.5°
	N10	DN-h5-h6	150-/-40	200-/-40	200-/-40	200-/-65	200-/-75	200-/-75	200-/-75	200-/-90	200-/-100	200-/-90	200-/-90
		R-α	840-310°	925-305°	925-305°	1025-305°	1100-310°	1100-310°	1100-310°	1175-310°	1250-310°	1300-310°	1300-310°
Bocchelli Camicia Jacket Nozzles	N21	DN	150	150	150	150	150	150	150	150	150	150	150
	N22	DN	200	250	250	250	250	250	250	250	250	250	250
	N23	DN	100	100	100	100	100	100	100	100	100	100	100
	N11	DN-α	80-90°	80-90°	80-90°	80-90°	80-90°	80-90°	80-90°	80-90°	100-90°	100-90°	100-90°
Gruppo Drive	Max torque	Nm	500	1400	1400	2800	2800	2800	2800	2800	2800	2800	2800
	h	mm	1431	1677	1677	1702	1702	1751	1751	1751	2016	2016	2016
	d5	mm	850	1000	1000	1000	1200	1200	1200	1300	1300	1300	1300
	na	Rpm	107	97	97	97	97	98	98	98	91	91	91
Turbina Turbine	Pa	kw	11	18.5	22	30	30	37	37	37	55	55	55