



- ❑ **63 to 6300 lt capacity**

- ❑ **Heating with jacket or half coil**

- ❑ **Agitator**

  - Anchor type

  - With retreat curved impeller

- ❑ **2 pieces execution**

  - top cover fully removable

  - Sealing with gasket + C-Clamps or bolts

- ❑ **Design conditions**

  - Pressure: -1 / 6 bar for vessel and jacket

  - Temperature: -25 / +200°C

- ❑ **Features**

  - Available for insulation and stainless steel cladding on lower and bottom head

  - Available for insulation and stainless steel cladding on top head

  - Available with top head in carbon steel nickel plating

  - Supportation: ring, brackets, legs according customer need

# DIN 28136 type AE Reactors 63 lt to 630 lt

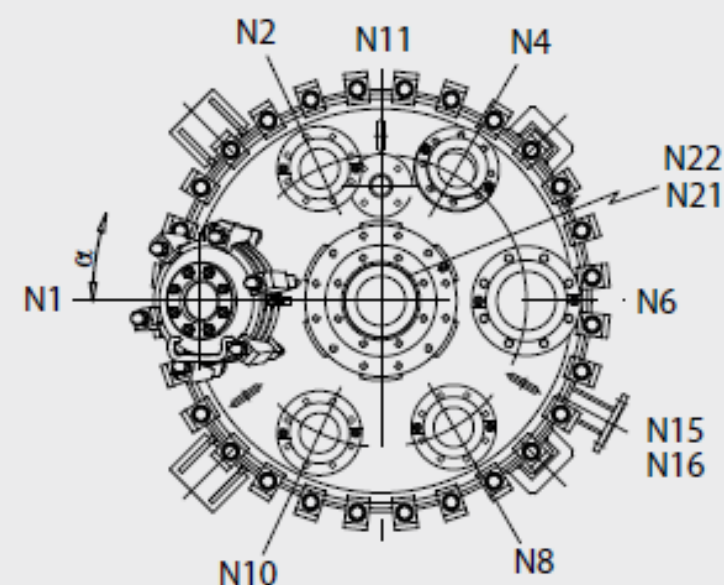
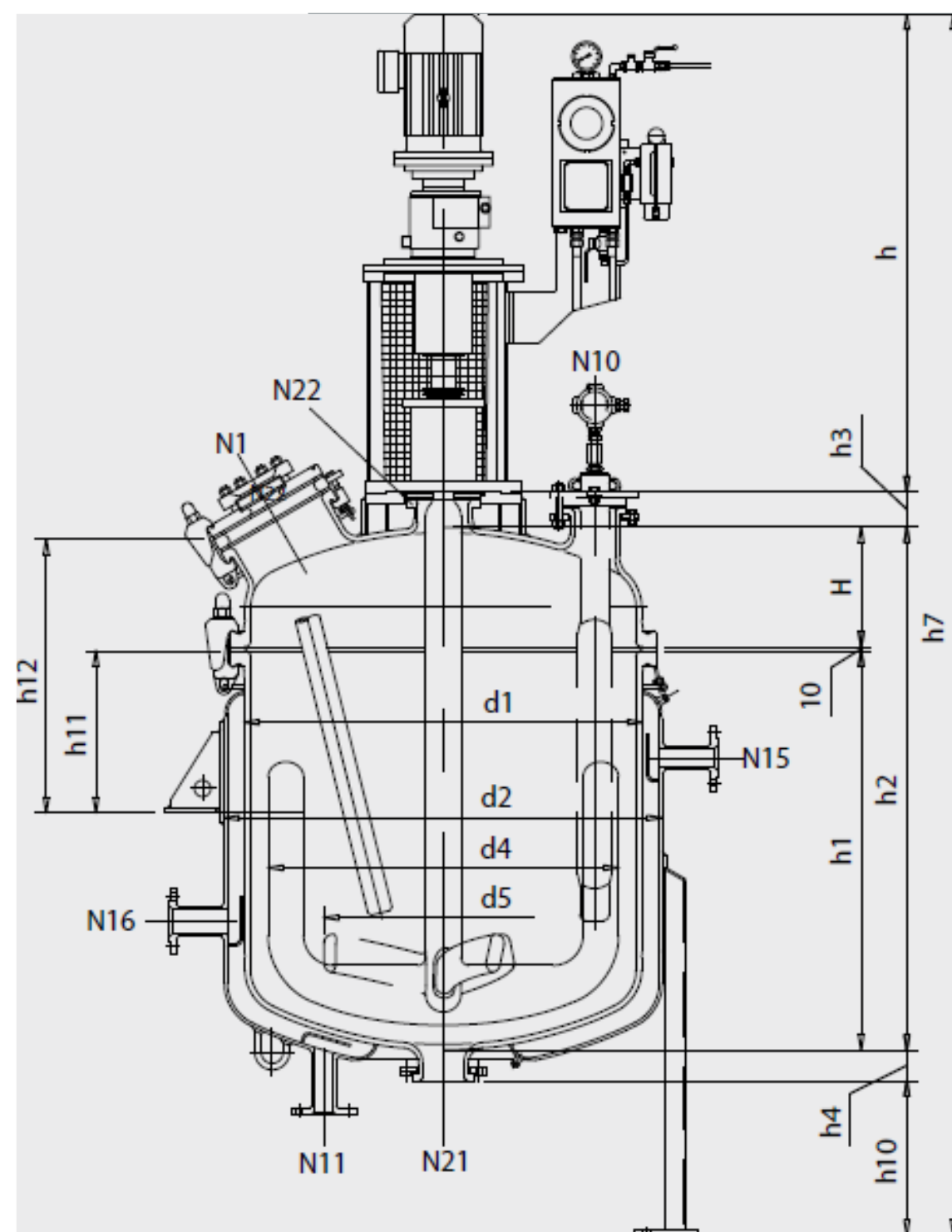

Type	Tipo	AE	63	100	160	250	400	630
Vessel capacity	Volume interno	l	97	135	215	335	545	865
Jacket capacity	Volume camicia	l	30	44	67	84	119	153
Jacketed area	Superficie incamiciata	m <sup>2</sup>	0.61	0.93	1.29	1.74	2.5	3.17
Weight	Peso	kg	510	550	650	970	1150	1510
Dimensioni Dimensions	d1	mm	508	508	600	700	800	1000
	d2	mm	600	600	700	800	900	1100
	H	mm	180	180	200	220	250	300
	h1	mm	400	600	700	800	1000	1000
	h2	mm	590	790	910	1030	1260	1310
	h3	mm	70	70	70	80	80	90
	h4	mm	70	70	70	70	80	78
	h7	mm	2341	2541	2661	2872	3212	3373
	h10 min.	mm	600	600	600	600	700	700
	h11 min.	mm	370	370	370	380	380	405
	h12 min.	mm	590	590	610	620	635	685
	h13 min.	mm	-	-	-	290	290	320
	h14 min.	mm	-	-	-	530	540	600
Bocchelli Nozzles	N1	DN	100	100	100	150	200	250
	N2	DN-h5	40-50	40-50	50-50	50-50	80-50	100-50
		R-α	210-65°	210-65°	240-65°	280-65°	310-65°	380-65°
	N4	DN-h5	80-0	80-0	80-0	80-0	80-0	100-0
		R-α	210-120°	210-120°	240-120°	280-120°	310-120°	380-120°
	N6	DN-h5	80-0	80-0	80-50	80-50	100-50	150-50
		R-α	210-180°	210-180°	240-180°	280-180°	310-180°	380-180°
	N8	DN-h5	50-50	50-50	80-50	80-50	80-50	100-50
		R-α	210-240°	210-240°	240-240°	280-240°	310-240°	380-240°
	N10	DN-h5	40-50	40-50	50-50	50-50	80-50	100-50
		R-α	210-295°	210-295°	240-295°	280-295°	310-295°	380-295°
	N21	DN	80	80	80	80	100	100
	N22	DN	50	50	50	80	80	125
	N23	DN	50	50	50	50	50	100
Bocchelli Camicia Jacket Nozzles	N11	DN	40	40	40	40	40	50
		α	90°	90°	90°	90°	90°	90°
	N15	DN	40	40	40	40	40	50
		α	208°	208°	208°	208°	208°	208°
	N16	DN	-	-	-	40	40	50
		α	-	-	-	208°	208°	208°
Gruppo Drive	Drive type	-	GNA-40	GNA-40	GNA-40	GNA-50	GNA-50	GNA-60
	Max torque	Nm	100	100	100	250	250	500
	h	mm	1011	1011	1011	1092	1092	1195
	d4	mm	420	420	500	600	700	880
Ancora Anchor	na	Rpm	108	108	108	90	90	74
	Pa	kw	0.75	0.75	0.75	1.5	1.5	2.2
	d5	mm	300	300	360	420	480	600
Impeller	ni	Rpm	160	160	160	145	145	117
	Pi	kw	0.75	0.75	0.75	1.5	1.5	3



# DIN 28136 type AE Reactors 1000 It to 6300 It

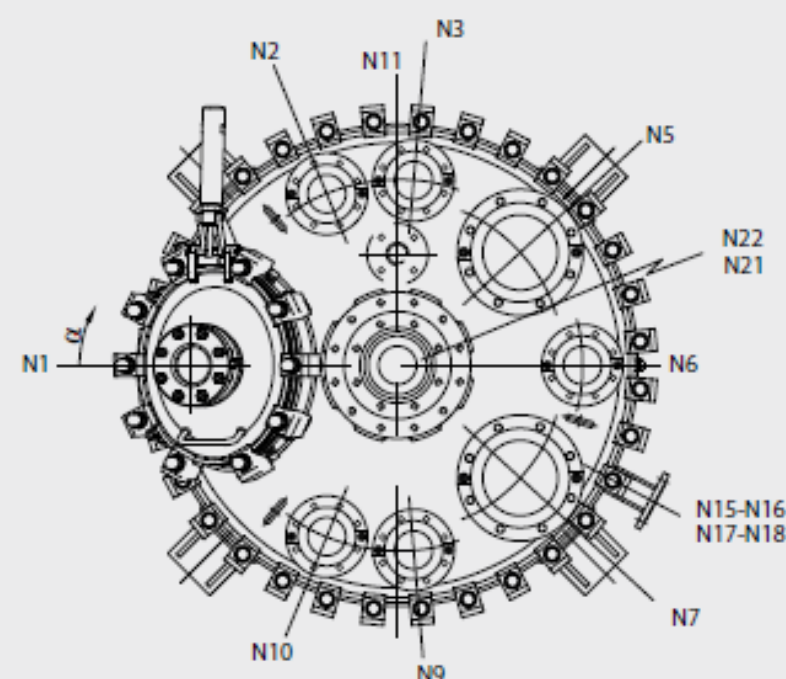
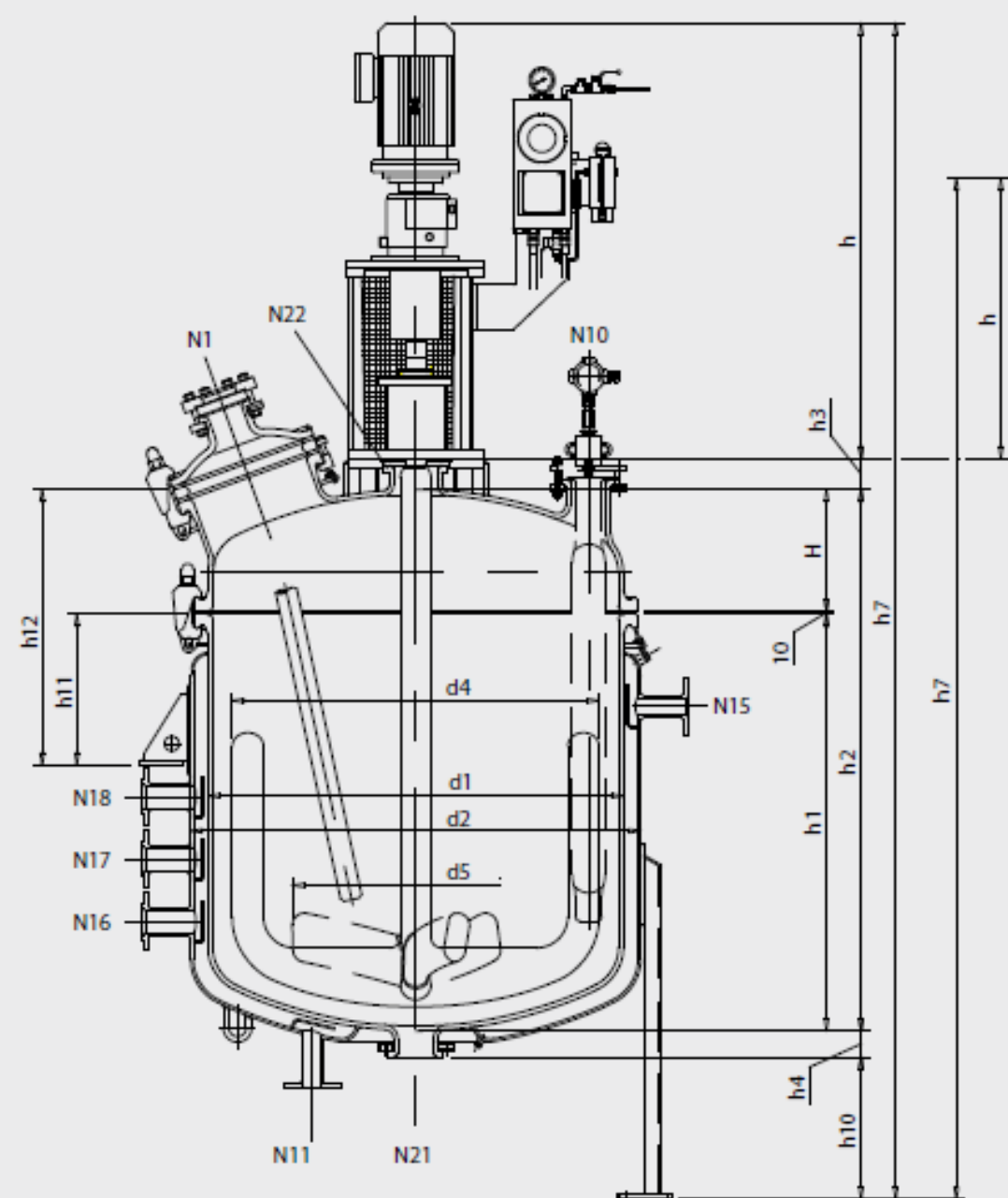

Type	Tipo	BE	1000	1600	2500	4000	6300
Vessel capacity	Volume interno	l	1485	2340	3500	5425	8820
Jacket capacity	Volume camicia	l	220	350	430	550	760
Jacketed area	Superficie incamiciata	m <sup>2</sup>	4.6	7.3	9.6	13.2	18
Weight	Peso	kg	2200	3100	5100	6100	7500
Dimensioni Dimensions	d1	mm	1200	1400	1600	1800	2000
	d2	mm	1300	1500	1700	1900	2100
	H	mm	240	280	320	360	400
	h1	mm	1560	1800	2060	2500	3050
	h3	mm	90	100	100	130	130
	h4	mm	76	74	72	70	86
	h7	mm	3621	3926	4209	4811	5602
	h10 min.	mm	700	700	700	700	900
	h11 min.	mm	320	380	380	545	535
	h12 min.	mm	530	600	620	810	820
	h13 min.	mm	310	240	240	250	270
	h14 min.	mm	520	460	480	515	555
Bochelli Nozzles	N1	DN	350/450	350/450	500	500	500
	N2	DN - h5	100 - 30	100 - 25	100 - 10	150 - 0	150 - 0
		R - α	500 - 67.5°	575 - 60°	675 - 65°	725 - 65°	800 - 60°
	N3	DN - h5	100 - 30	100 - 25	100 - 10	150 - 0	150 - 0
		R - α	500 - 95°	575 - 95°	675 - 95°	725 - 95°	800 - 95°
	N5	DN - h5	200 - 60	200 - 50	200 - 50	250 - 25	250 - 25
		R - α	450 - 137.5°	550 - 135°	625 - 135°	675 - 135°	750 - 135°
	N6	DN - h5	100 - 30	100 - 25	100 - 10	150 - 0	150 - 0
		R - α	500 - 180°	575 - 180°	675 - 180°	725 - 180°	800 - 180°
	N7	DN - h5	200 - 60	200 - 50	200 - 50	250 - 25	250 - 25
		R - α	450 - 222.5°	550 - 225°	625 - 225°	675 - 225°	750 - 225°
	N9	DN - h5	100 - 30	100 - 25	100 - 10	150 - 0	150 - 0
		R - α	500 - 265°	575 - 265°	675 - 265°	725 - 265°	800 - 265°
	N10	DN - h5	100 - 30	100 - 25	100 - 10	150 - 0	150 - 0
		R - α	500 - 292.5°	575 - 300°	675 - 295°	725 - 295°	800 - 300°
	N21	DN	100	100	100	100	150
Bochelli Camicia Jacket Nozzles	N22	DN	125	150	150	200	200
	N23	DN	100	100	100	100	100
	N11	DN - α	50 - 90°	50 - 90°	50 - 90°	50 - 90°	80 - 90°
	N15	DN - α	50 - 208°	50 - 208°	50 - 208°	50 - 208°	80 - 208°
	N16	DN - α	50 - 208°	50 - 208°	50 - 208°	50 - 208°	50 - 208°
Gruppo Drive	Drive type	-	GNA-60	GRO-80	GRO-80	GRO-100	GRO-100
	Max torque	Nm	500	1400	1400	2800	2800
	h	mm	1195	1247	1272	1406	1431
	h	mm	1195	1247	1272	1406	1431
Turbina Turbine	d5	mm	625	625	740	740	740
	na	Rpm	120	103	104	105	107
	Pa	kw	3	4	5.5	7.5	11